

DIVISION: 06 00 00 – WOOD, PLASTICS AND COMPOSITES
Section: 06 53 00 – Plastic Decking

REPORT HOLDER:
TruNorth Composites Inc.
Unit 3, 490 Elgin Street
Brantford, ON, N3S 7P8
905-265-0022
www.TruNorthDeck.com

REPORT SUBJECT:
TRUNORTHDECK™ Composite Deck Boards
Enviroboard
Accuspan Square Edge
Accuspan CAP
Accuspan Square Edge CAP

1.0 SCOPE OF EVALUATION

1.1 This Research Report addresses compliance with the following Codes:

- 2021 and 2018 *International Building Code*® (IBC)
- 2021 and 2018 *International Residential Code*® (IRC)

NOTE: This report references the most recent Code editions noted. Section numbers in earlier editions may differ.

1.2 TRUNORTHDECK™ Composite Deck Boards have been evaluated for the following properties (see Table 1):

- Structural Performance
- Durability
- Surface Burning
- Decay Resistance
- Termite Resistance

1.3 TRUNORTHDECK™ Composite Deck Boards are intended for use as a walking surface on exterior decks, balconies, porches, and walkways, including stairs.

2.0 STATEMENT OF COMPLIANCE

TRUNORTHDECK™ Composite Deck Boards comply with the Codes listed in Section 1.1, for the properties stated in Section 1.2, and uses stated in Section 1.3, when installed as described in this report, including the Conditions of Use stated in Section 6.0.

3.0 DESCRIPTION

3.1 TRUNORTHDECK™ Composite Deck Boards: Provided in hollow and solid cross-sections, with flat and grooved edges. See Tables 1a and 1b and Figures 1 and 2.

- Enviroboard: Hollow core deck board with grooved edges (5.125 in. x 0.975 in.)
- Accuspan Square Edge: Solid core deck board with square edges (5.125 in. x 0.938 in.)
- Accuspan CAP: Solid with grooved edges (0.940 in. x 5.125 in.)
- Accuspan Square Edge CAP: Solid with square edges (0.9375 in. x 5.125 in.)

3.2 Slide & Go® Fastening Clips: Injection molded thermoplastic clips provided to permit hidden attachment of grooved edge deck boards to supports. See Tables 1a and 1b and Figures 3 and 4.

4.0 PERFORMANCE CHARACTERISTICS

4.1 Uniform Live Load Ratings: See Table 3 for the corresponding deck boards and fasteners indicated.

4.2 Stair Treads: Deck boards used as stair treads are rated for the Code-prescribed concentrated load equal to 300 lb. when installed with a maximum span indicated in Table 3. Deck boards used as stair treads must be installed in a minimum two-span condition.

4.3 Wind Uplift Resistance Ratings: Given in Table 2 for the corresponding deck boards and fasteners indicated.



4.4 Surface Burning Characteristics: TRUNORTHDECK™ Composite Deck Boards have a flame spread index not exceeding 200, when tested in accordance with ASTM E84.

4.5 Termite and Decay Resistance: Materials used are deemed equivalent to preservative treated or naturally durable wood for resistance to weathering effects, attack from Eastern subterranean termites, and fungus decay.

4.6 Structural Performance: Structural performance has been demonstrated for a temperature range from -20°F (-29°C) to 125°F (52°C).

5.0 INSTALLATION

5.1 General: TRUNORTHDECK™ Composite Deck Boards must be installed in accordance with the manufacturer's published installation instructions, the applicable Code, and this Research Report. A copy of the manufacturer's instructions must be available on the jobsite during installation.

5.2 Application: Flat edge boards must be face-fastened and require two fasteners at every joist, 3/4 in. from the side and at least 3/4 in. from the end of the board.

Grooved edge hollow cross-section deck boards (Enviroboard) must be secured with Slide & Go® Fastening Clips (specified in Table 2) at each joist.

Flat edge solid cross-section boards (Accuspan Square Edge/ Accuspan Square Edge CAP) must be face-fastened and require two fasteners at every joist, 3/4 in. from the edge and at least 3/4 in. from the end of the board.

Table 2 details the type of fasteners that are to be used for each installation.

6.0 CONDITIONS OF USE

The TRUNORTHDECK™ Composite Deck Boards identified in this report are deemed to comply with the intent of the provisions of the referenced Building Codes subject to the following conditions.

6.1 Installation must comply with this Research Report, the manufacturer's published installation instructions, and the applicable Code. In the event of a conflict, this report governs.

6.2 The deck boards are limited to use in Type V-B construction.

6.3 Deck boards placed at an angle other than 90 degrees to the supporting joist will require support framing at a reduced spacing such that the span of the deck board does not exceed the span identified in Table 2.

6.4 The wind uplift resistance rating recognized in this report is based on attachment to No. 2 Structural Grade Spruce-Pine-Fir (SPF). Installation on wood framing with a lesser grading may result in a lower wind uplift rating.

6.5 The compatibility of the metal fasteners, metal post mount components, and other hardware with the supporting structure, including chemically treated wood, is outside the scope of this report and is subject to approval by the Code official.

6.6 Where required by the building official, engineering calculations and details shall be provided. The calculations shall verify that the anchorage complies with the Building Code for the type of framing and condition of the supporting construction.

6.7 The composite deck boards are manufactured in Brantford, Ontario, Canada, in accordance with the manufacturer's approved quality control system under a quality control program with inspections by Intertek Testing Services NA, Inc.

7.0 SUPPORTING EVIDENCE

7.1 Reports of testing demonstrating compliance with ICC-ES AC174, Acceptance Criteria for Deck Board Span Ratings and Guardrail Systems (Guards and Handrails), approved January 2012 (editorially revised February 2014).

7.2 Reports of testing and engineering analysis demonstrating compliance with the performance requirements of ASTM D7032-21, Standard Specification for Establishing Performance Ratings for Wood-Plastic Composite Deck Boards and Guardrail Systems (Guards or Handrails).

7.3 Manufacturer's drawings and installation instructions.





7.4 Intertek Listing Report "TruNorth Composites Deck Boards", on the [Intertek Directory of Building Products](#).

8.0 IDENTIFICATION

The TRUNORTHDECK™ Composite Deck Boards are identified with the manufacturer's name (TruNorth Composites, Inc.), the product name, the Intertek Mark as shown below, the Intertek Control Number and the Code Compliance Research Report number (CCRR-0541).



9.0 OTHER CODES

This section is not applicable.

10.0 CODE COMPLIANCE RESEARCH REPORT USE

10.1 Approval of building products and/or materials can only be granted by a building official having legal authority in the specific jurisdiction where approval is sought.

10.2 Code Compliance Research Reports shall not be used in any manner that implies an endorsement of the product by Intertek.

10.3 Reference to the <https://bpdirectory.intertek.com> is recommended to ascertain the current version and status of this report.

This Code Compliance Research Report ("Report") is for the exclusive use of Intertek's Client and is provided pursuant to the agreement between Intertek and its Client. Intertek's responsibility and liability are limited to the terms and conditions of the agreement. Intertek assumes no liability to any party, other than to the Client in accordance with the agreement, for any loss, expense or damage occasioned by the use of this Report. Only the Client is authorized to permit copying or distribution of this Report and then only in its entirety, and the Client shall not use the Report in a misleading manner. Client further agrees and understands that reliance upon the Report is limited to the representations made therein. The Report is not an endorsement or recommendation for use of the subject and/or product described herein. This Report is not the Intertek Listing Report covering the subject product and utilized for Intertek Certification and this Report does not represent authorization for the use of any Intertek certification marks. Any use of the Intertek name or one of its marks for the sale or advertisement of the tested material, product or service must first be approved in writing by Intertek.



545 E. Algonquin Road • Arlington Heights • Illinois • 60005
intertek.com/building





Table 1a – TRUNORTHDECK™ Product Description

Decking Plank	Description	Surface Descriptions	Color(s)
Enviroboard	0.975" x 5.125" Hollow with Grooved Edges	Textured with Embossed Wood Pattern	Cedar, Maple, Chestnut, Mahogany and Heritage Grey
Accuspan Square Edge	0.9375" x 5.125" Solid with Square Edges	Textured with Embossed Wood Pattern	
Accuspan CAP	0.940" x 5.125" Solid with Grooved Edges	Textured with Embossed Wood Pattern	The premium capped colours are: Sable (Mocha), Caramel, Stone Grey and Bordeaux. The variegated capped colours: Ash Grey, Brazilian cherry, Tropical Walnut, Tigerwood, Amazon Grey, Hazelwood
Accuspan Square Edge CAP	0.9375" x 5.125" Solid with Square Edges	Textured with Embossed Wood Pattern	

Table 1b – TRUNORTHDECK™ Product Description

Product	WPC Core ¹	PVC Core	WPC Cap	Polymer Cap	PVC Cap	Full Cap	Semi Cap	Co-Extruded	Mono-Extruded
Enviroboard	X								X
Accuspan Square Edge	X								X
Accuspan CAP	X			X		X		X	
Accuspan Square Edge CAP	X			X		X		X	

WPC is Wood Plastic Composite comprised of high density polyethylene (HDPE) and rice hulls.



545 E. Algonquin Road • Arlington Heights • Illinois • 60005
intertek.com/building



PCA-101

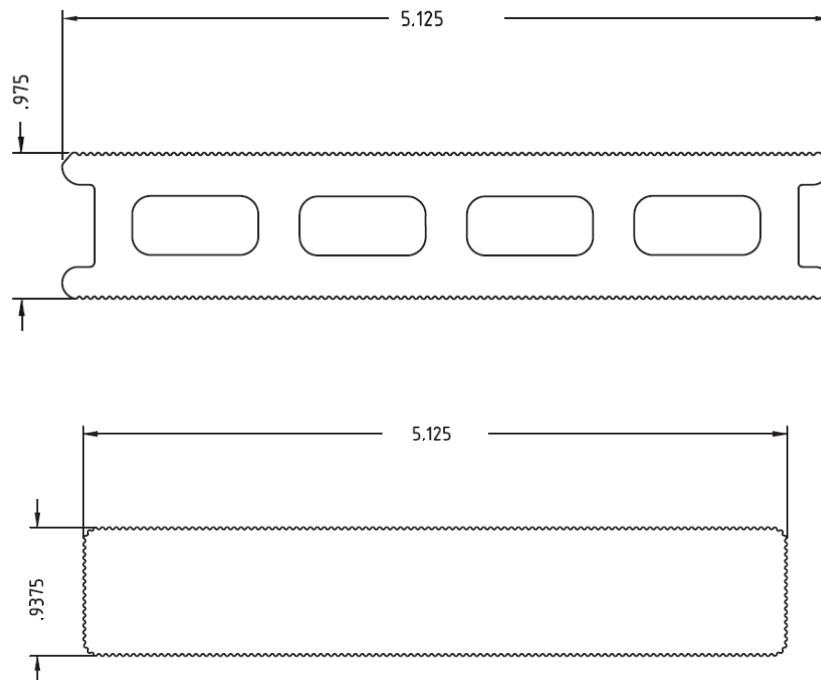

Table 2 – Wind Uplift Resistance

Decking Plank	Span/Load Rating ¹	Stair Tread Span ² (in.)	Fastener ³	Wind Uplift Resistance ³ (psf)
Enviroboard ⁴	16/100	Not Allowed	Slide & Go [®] Hidden Fastening Clip	115
Accuspan CAP ⁴	16/100	Not Allowed	Slide & Go [®] Hidden Fastening Clip	115
Accuspan Square Edge / Accuspan Square Edge CAP	16/100	12	#8 x 2.5" Deck Screw	441

- ¹ Span/Load rating is the maximum span in inches and the maximum allowable live load in pounds per square foot (psf).
- ² Stair tread span is based on a continuous deck board over two or more equal spans (3 supports).
- ³ Wind uplift resistance is based on two fasteners at each support (wood joist) except Grooved Edge Boards which use one hidden clip and fastener located at each joist. Values have been adjusted for wind load duration and end use. No further adjustments shall be made.
- ⁴ Grooved Deck Boards may not be used as stair treads.

Figure 1 – TRUNORTHDECK™ Composite Deck Boards – Mono-Extruded (Enviroboard, Accuspan Square Edge)



545 E. Algonquin Road • Arlington Heights • Illinois • 60005
intertek.com/building



Figure 2 – TRUNORTHDECK™ Composite Deck Boards – Co-Extruded (Accuspan Cap and Accuspan Square Edge Cap)

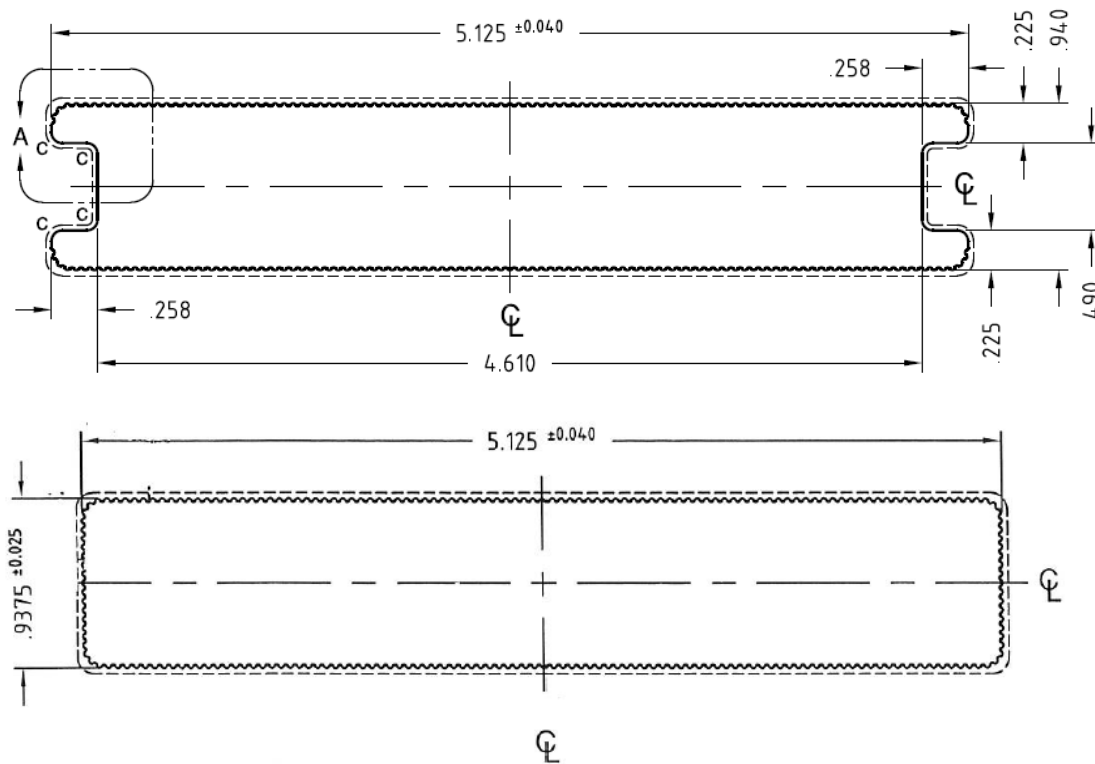

Figure 3 – Enviroboard, Grooved Edge Installation

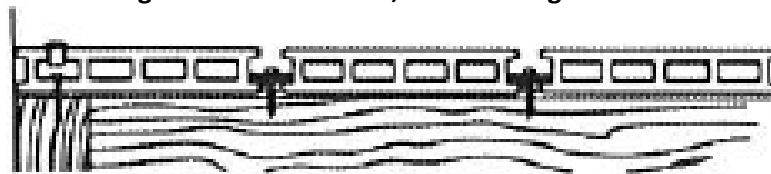

Figure 4 – Slide & Go® Hidden Fastener

